



300Mbps Wireless N ADSL2+ Modem Router

N300 with Proven Stability



TD-W8961N

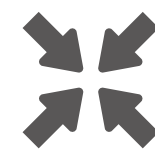

ADSL modem +
Wireless Router



300Mbps
Wireless Speed

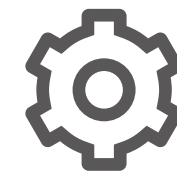

Easy Setup

Features



Speed

- **Quick, everyday Wi-Fi** – 300Mbps Wi-Fi allows stable speed for wireless activities, such as streaming, surfing, browsing and posting social media
- **Fast Ethernet** – Fast Ethernet port for rapid, reliable wired connections to desktops, game consoles and IPTVs

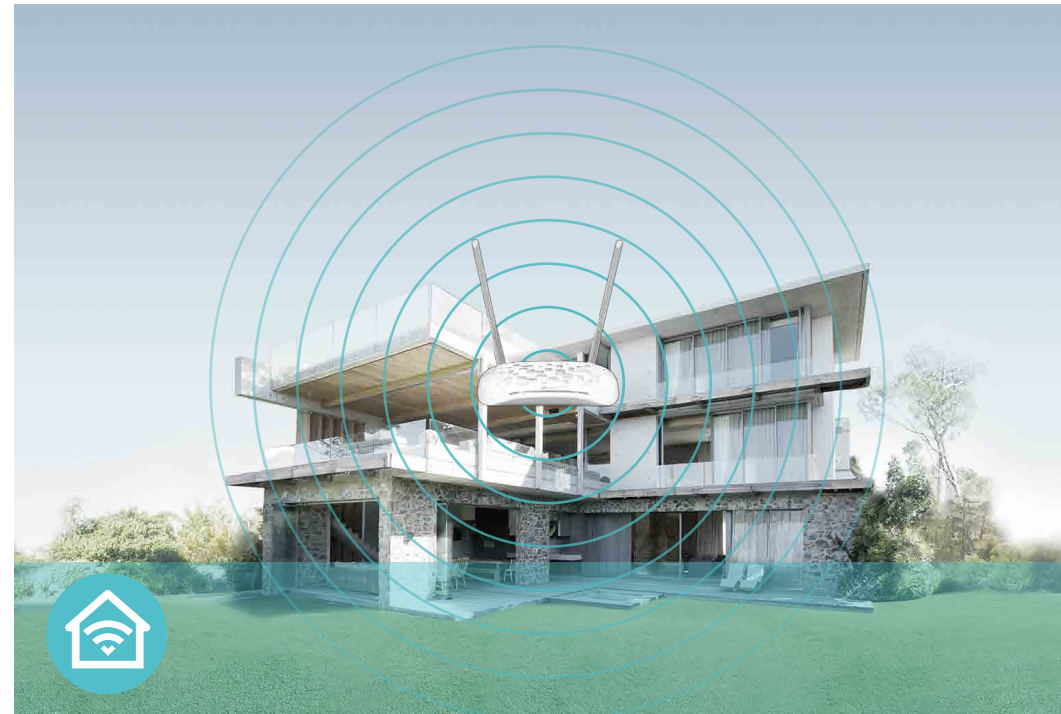

Wi-Fi Range

- **Superior Coverage** – Two 5dBi high-gain antennas open network coverage across your home and 2 × 2 MIMO technology improves signal stability



Reliability

- **IPv6** – Compatible with IPv6 (Internet Protocol version 6)
- **IPTV** – Supports Bridge for smooth IPTV application
- **Quality of Service** – Prioritises data transmission according to IPP/ToS, DSCP and 802.1p

Features



Ease of Use

- Intuitive Web UI– Ensures quick and simple installation without hassle
- Fast Encryption – One-touch WPA wireless security encryption with the WPS button
- Wi-Fi On/Off – Allows users to simply turn their wireless radio on or off
- Power On/Off – Conveniently power on or off your router as required



Security

- SPI & NAT Firewall – Protects end-user devices from potential attacks from across the Internet
- Guest Network – Provides separate access for guests while securing the home network
- Encryptions for Secure Network – WPA-PSK/WPA2- PSK encryptions provide active protection against security threats

Specifications

Hardware

- Ports: 4 10/100Mbps LAN Ports & 1 RJ 11 Port
- Button: Power On/Off Button, WiFi On/Off Button, WPS/RESET Button,
- Antenna: 2 × 5dBi Fixed Omni-Directional Antenna
- External Power Supply: 9V/0.6A
- Dimensions (W x D x H): 7.7 × 5.1 × 1.4 in (195 × 130 × 36mm)

Wireless

- Wireless Standard: IEEE 802.11g, 802.11b, 802.11n
- Compatibility: ADSL2+/ADSL2/ADSL
- Transmit Power: <20dBm(EIRP)
- Wireless Security: Support 64/128 bit WEP, WPA-PSK/WPA2-PSK

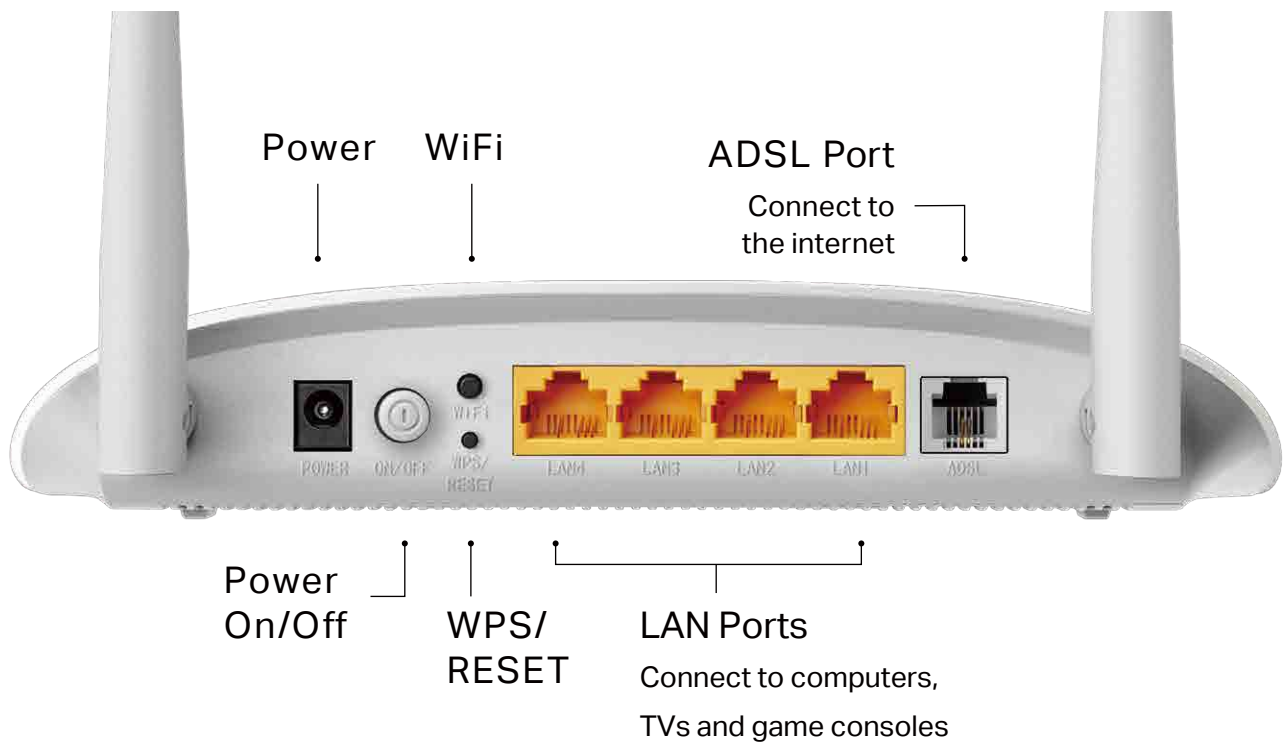

Specifications

Software

- Quality of Service: QoS Remarking based on IPP/ToS, DSCP and 802.1p
- Security: NAT Firewall, SPI Firewall, MAC / IP / Packet / Application / URL Filtering, Denial of Service (DoS), SYN Flooding, Ping of Death
- Management: Web Based Configuration (HTTP), Remote management, Telnet management, Command Line Interface, SSL for TR-069, SNMP v1/2c, SNMP over EOC, Web Based Firmware Upgrade, CWMP (TR-069), Diagnostic Tools
- Port Forwarding: Virtual Server, DMZ, ACL (Access Control List)
- VPN Pass-Through: PPTP, L2TP, IPSec Pass-through
- ATM/PPP Protocols: ATM Forum UNI3.1/4.0, PPP over ATM (RFC 2364), PPP over Ethernet (RFC2516), IPoA (RFC1577/2225), PVC - Up to 8 PVCs
- Advanced Features:
Traffic Shaping (ATM QoS) UBR, CBR, VBR-rt, VBR-nrt;
Dynamic Host Configuration Protocol (DHCP), DHCP relay;
Network Address Translation (NAT);
PVC/Ethernet Port Mapping VLAN, 802.1P, Static Routing, RIP v1/v2 (optional);
DNS Relay, DDNS, IGMP snooping V1/2, IGMP Multicast, UPnP

Others

- Certification
CE, RoHS
- System Requirements
Windows, Mac, Linux
- Environment
Operating Temperature: 0℃~40℃ (32°F ~104°F)
Storage Temperature: -40℃~70℃ (-40°F ~158°F)
Operating Humidity: 10%~90% non-condensing
Storage Humidity: 5%~90% non-condensing
- Package Contents
DSL Modem Router TD-W8961N
External DSL Splitter
RJ11 DSL Cable
RJ45 Ethernet Cable
Quick Installation Guide
Power Adapter



For more information, please visit
<http://www.tp-link.com/en/products/details/?model=TD-W8961N>
or scan the QR code left

Specifications are subject to change without notice. TP-Link is a registered trademark of TP-Link Technologies Co., Ltd. Other brands and product names are trademarks or registered trademarks of their respective holders. Copyright ©2017 TP-Link Technologies Co., Ltd. All rights reserved.